

GN 360 | Levelling bushing

Steel or stainless steel



- 1
- 2
- 3
- 4
- 5
- 6
- 7
- 8
- 9
- 10
- 11
- 12
- 13
- 14
- 15
- 16
- 17
- 18
- 19

STANDARD EXECUTIONS

Zinc-plated steel:

- **GN 360-A-ST**: without locking nut.
- **GN 360-B-ST**: with locking nut.

AISI 304 stainless steel:

- **GN 360-A-NI**: without locking nut.
- **GN 360-B-NI**: with locking nut.

FEATURES AND APPLICATIONS

GN 360 bushings are used for levelling and to compensate for any slopes when setting up machines.

D2 pass-through threading can also be used to fix the lower part of the bushing.

The fine pitch d3 threading allows for precision adjustment of the bushing and its eventual adjustment using a wrench.

An elastic ring limits the maximum adjustment stroke.

Dimensions GN 360-40/52/65: d1=d4

Dimensions GN 360-79/99/119: d4<d1

ACCESSORIES ON REQUEST

DIN 1810 spanner wrench



Application examples

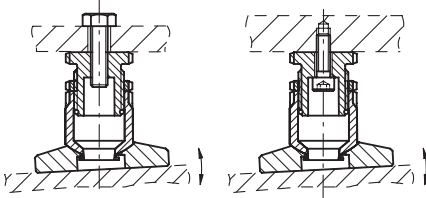

GN 360-A-ST

GN 360-B-ST

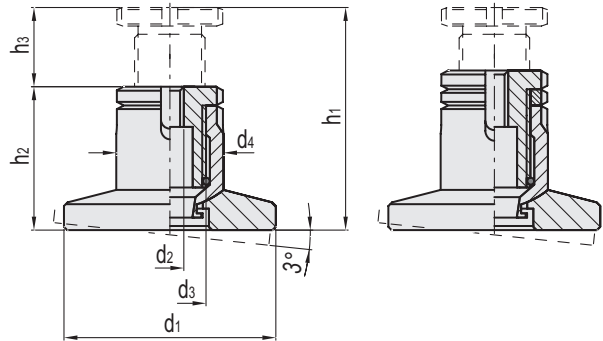

GN 360-A-ST

| Code | Description | d1 | d2 | d3 | d4 | h1 | h2 | h3 | Static load [kN] | ⚖️ |
|----------|-------------------------|-----|-----|-----------|----|-----|-----|----|------------------|------|
| GN.18503 | GN 360-40-M10-69-A-ST | 40 | M10 | M28 x 1.5 | 40 | 69 | 53 | 16 | 100 | 389 |
| GN.18511 | GN 360-40-M10-86-A-ST | 40 | M10 | M28 x 1.5 | 40 | 86 | 62 | 24 | 100 | 454 |
| GN.18527 | GN 360-52-M12-80-A-ST | 52 | M12 | M36 x 1.5 | 52 | 80 | 61 | 19 | 125 | 808 |
| GN.18519 | GN 360-52-M12-103-A-ST | 52 | M12 | M36 x 1.5 | 52 | 103 | 73 | 30 | 125 | 965 |
| GN.18535 | GN 360-65-M16-112-A-ST | 65 | M16 | M45 x 1.5 | 65 | 112 | 82 | 30 | 225 | 1600 |
| GN.18543 | GN 360-65-M16-148-A-ST | 65 | M16 | M45 x 1.5 | 65 | 148 | 100 | 48 | 225 | 2024 |
| GN.18551 | GN 360-79-M10-69-A-ST | 79 | M10 | M28 x 1.5 | 40 | 69 | 53 | 16 | 100 | 725 |
| GN.18559 | GN 360-79-M10-86-A-ST | 79 | M10 | M28 x 1.5 | 40 | 86 | 62 | 24 | 100 | 789 |
| GN.18575 | GN 360-99-M12-80-A-ST | 99 | M12 | M36 x 1.5 | 52 | 80 | 61 | 19 | 125 | 1414 |
| GN.18567 | GN 360-99-M12-103-A-ST | 99 | M12 | M36 x 1.5 | 52 | 103 | 73 | 30 | 125 | 1575 |
| GN.18583 | GN 360-119-M16-112-A-ST | 119 | M16 | M45 x 1.5 | 65 | 112 | 82 | 30 | 225 | 2805 |
| GN.18591 | GN 360-119-M16-148-A-ST | 119 | M16 | M45 x 1.5 | 65 | 148 | 100 | 48 | 225 | 3205 |

GN 360-B-ST

| Code | Description | d1 | d2 | d3 | d4 | h1 | h2 | h3 | Static load [kN] | ⚖️ |
|----------|-------------------------|-----|-----|-----------|----|-----|-----|----|------------------|------|
| GN.18507 | GN 360-40-M10-69-B-ST | 40 | M10 | M28 x 1.5 | 40 | 69 | 59 | 10 | 100 | 415 |
| GN.18515 | GN 360-40-M10-86-B-ST | 40 | M10 | M28 x 1.5 | 40 | 86 | 68 | 18 | 100 | 479 |
| GN.18531 | GN 360-52-M12-80-B-ST | 52 | M12 | M36 x 1.5 | 52 | 80 | 69 | 11 | 125 | 860 |
| GN.18523 | GN 360-52-M12-103-B-ST | 52 | M12 | M36 x 1.5 | 52 | 103 | 80 | 23 | 125 | 1017 |
| GN.18539 | GN 360-65-M16-112-B-ST | 65 | M16 | M45 x 1.5 | 65 | 112 | 90 | 22 | 225 | 1500 |
| GN.18547 | GN 360-65-M16-148-B-ST | 65 | M16 | M45 x 1.5 | 65 | 148 | 108 | 40 | 225 | 2121 |
| GN.18555 | GN 360-79-M10-69-B-ST | 79 | M10 | M28 x 1.5 | 40 | 69 | 59 | 10 | 100 | 750 |
| GN.18563 | GN 360-79-M10-86-B-ST | 79 | M10 | M28 x 1.5 | 40 | 86 | 68 | 18 | 100 | 814 |
| GN.18579 | GN 360-99-M12-80-B-ST | 99 | M12 | M36 x 1.5 | 52 | 80 | 69 | 11 | 125 | 1465 |
| GN.18571 | GN 360-99-M12-103-B-ST | 99 | M12 | M36 x 1.5 | 52 | 103 | 80 | 23 | 125 | 1620 |
| GN.18587 | GN 360-119-M16-112-B-ST | 119 | M16 | M45 x 1.5 | 65 | 112 | 90 | 22 | 225 | 2900 |
| GN.18595 | GN 360-119-M16-148-B-ST | 119 | M16 | M45 x 1.5 | 65 | 148 | 100 | 40 | 225 | 3295 |

Standard machine parts

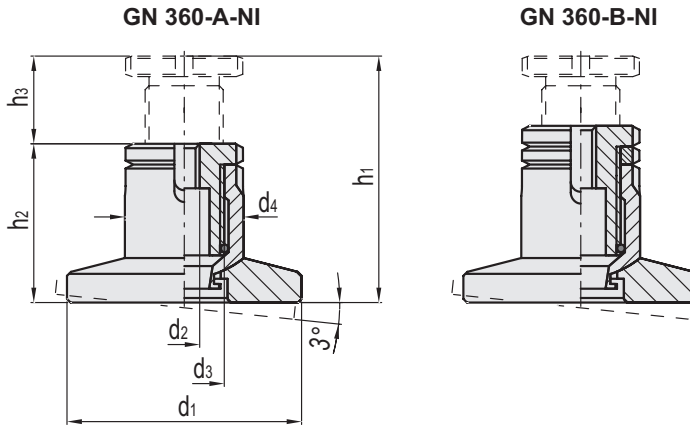

GN 360-A-NI

INOX STAINLESS STEEL

| Code | Description | d1 | d2 | d3 | d4 | h1 | h2 | h3 | Static load [kN] | ⚖ |
|----------|-------------------------|-----|-----|-----------|----|-----|-----|----|------------------|------|
| GN.18501 | GN 360-40-M10-69-A-NI | 40 | M10 | M28 x 1.5 | 40 | 69 | 53 | 16 | 70 | 390 |
| GN.18509 | GN 360-40-M10-86-A-NI | 40 | M10 | M28 x 1.5 | 40 | 86 | 62 | 24 | 70 | 460 |
| GN.18525 | GN 360-52-M12-80-A-NI | 52 | M12 | M36 x 1.5 | 52 | 80 | 61 | 19 | 85 | 815 |
| GN.18517 | GN 360-52-M12-103-A-NI | 52 | M12 | M36 x 1.5 | 52 | 103 | 73 | 30 | 85 | 975 |
| GN.18533 | GN 360-65-M16-112-A-NI | 65 | M16 | M45 x 1.5 | 65 | 112 | 82 | 30 | 155 | 1665 |
| GN.18541 | GN 360-65-M16-148-A-NI | 65 | M16 | M45 x 1.5 | 65 | 148 | 100 | 40 | 155 | 2048 |
| GN.18549 | GN 360-79-M10-69-A-NI | 79 | M10 | M28 x 1.5 | 40 | 69 | 53 | 16 | 70 | 730 |
| GN.18557 | GN 360-79-M10-86-A-NI | 79 | M10 | M28 x 1.5 | 40 | 86 | 62 | 24 | 70 | 825 |
| GN.18573 | GN 360-99-M12-80-A-NI | 99 | M12 | M36 x 1.5 | 52 | 80 | 61 | 19 | 85 | 1425 |
| GN.18565 | GN 360-99-M12-103-A-NI | 99 | M12 | M36 x 1.5 | 52 | 103 | 73 | 30 | 85 | 1595 |
| GN.18581 | GN 360-119-M16-112-A-NI | 119 | M16 | M45 x 1.5 | 65 | 112 | 82 | 30 | 155 | 2880 |
| GN.18589 | GN 360-119-M16-148-A-NI | 119 | M16 | M45 x 1.5 | 65 | 148 | 100 | 40 | 155 | 3260 |

GN 360-B-NI

INOX STAINLESS STEEL

| Code | Description | d1 | d2 | d3 | d4 | h1 | h2 | h3 | Static load [kN] | ⚖ |
|----------|-------------------------|-----|-----|-----------|----|-----|-----|----|------------------|------|
| GN.18505 | GN 360-40-M10-69-B-NI | 40 | M10 | M28 x 1.5 | 40 | 69 | 59 | 10 | 70 | 418 |
| GN.18513 | GN 360-40-M10-86-B-NI | 40 | M10 | M28 x 1.5 | 40 | 86 | 68 | 18 | 70 | 480 |
| GN.18529 | GN 360-52-M12-80-B-NI | 52 | M12 | M36 x 1.5 | 52 | 80 | 69 | 11 | 85 | 897 |
| GN.18521 | GN 360-52-M12-103-B-NI | 52 | M12 | M36 x 1.5 | 52 | 103 | 80 | 23 | 85 | 1498 |
| GN.18537 | GN 360-65-M16-112-B-NI | 65 | M16 | M45 x 1.5 | 65 | 112 | 90 | 22 | 155 | 1758 |
| GN.18545 | GN 360-65-M16-148-B-NI | 65 | M16 | M45 x 1.5 | 65 | 148 | 108 | 40 | 155 | 2145 |
| GN.18553 | GN 360-79-M10-69-B-NI | 79 | M10 | M28 x 1.5 | 40 | 69 | 59 | 10 | 70 | 755 |
| GN.18561 | GN 360-79-M10-86-B-NI | 79 | M10 | M28 x 1.5 | 40 | 86 | 68 | 18 | 70 | 800 |
| GN.18577 | GN 360-99-M12-80-B-NI | 99 | M12 | M36 x 1.5 | 52 | 80 | 69 | 11 | 85 | 1031 |
| GN.18569 | GN 360-99-M12-103-B-NI | 99 | M12 | M36 x 1.5 | 52 | 103 | 80 | 23 | 85 | 1645 |
| GN.18585 | GN 360-119-M16-112-B-NI | 119 | M16 | M45 x 1.5 | 65 | 112 | 90 | 22 | 155 | 2980 |
| GN.18593 | GN 360-119-M16-148-B-NI | 119 | M16 | M45 x 1.5 | 65 | 148 | 108 | 40 | 155 | 3360 |